

# CALDWELL®

# HYDROSLED™

## Assembly, Use and Care Instructions

Product #1093568

Instruction #1097982 Rev. B



Thank you for purchasing the Caldwell® Hydrosled™ Shooting Rest. To insure proper function of your new rest, please follow the instructions carefully.

### STOP!

If you have a problem with this product, **DON'T RETURN IT TO THE STORE WHERE YOU PURCHASED IT.**



1800 North Route Z  
Columbia, MO 65202

Have an issue with this product? Please contact customer service by filling out the form on the contact page of our website at [www.BTibrands.com/](http://www.BTibrands.com/) or call us at: 1-877-509-9160

**NOT WARRANTED AGAINST MISUSE, ABUSE, OR COMMERCIAL USE.**

#### Limited Warranty

Every Caldwell product is warranted to be free of defects in materials and workmanship for a period of one (1) year from the date of original purchase. Caldwell will, at its option, repair or replace without charge, except for transportation costs, parts that fail under normal use and service when operated and maintained in accordance with our Instructions. This warranty does not apply to normal wear or to items whose life is dependent upon their use and care. This warranty is in lieu of all other warranties, expressed or implied and releases Caldwell, its affiliates, and its vendors from all other obligations and liabilities.

**⚠ IMPORTANT SAFETY INFORMATION ⚠**

- Always practice safe firearm handling.
- Always unload and remove the firearm before attempting to add or remove weight from the weight reservoir.
- Always hold the forend of the firearm when shooting off of the Hydrosled™. If it is not held, the captured recoil can cause the forend of the firearm to jump out of the Front Rest possibly causing damage to the firearm or injuring the shooter.

Please take a moment to locate all the parts shown in this photo.  
Some components may vary slightly in appearance.

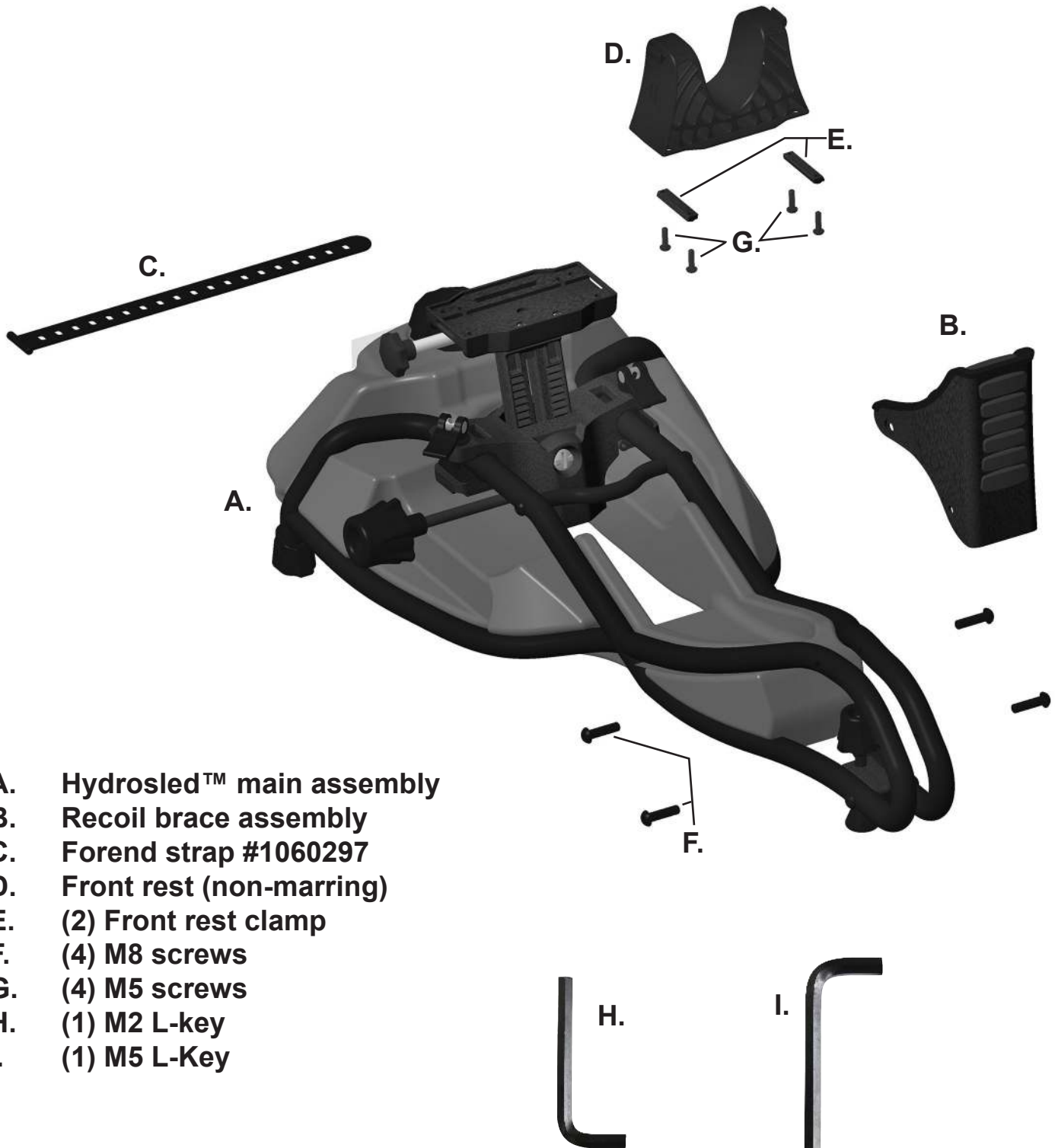

- A. Hydrosled™ main assembly
- B. Recoil brace assembly
- C. Forend strap #1060297
- D. Front rest (non-marring)
- E. (2) Front rest clamp
- F. (4) M8 screws
- G. (4) M5 screws
- H. (1) M2 L-key
- I. (1) M5 L-Key

# ASSEMBLY

## Skeletonized Front Cradle Assembly

1. Position the **Skeletonized Front Rest(D)** onto the cradle plate and insert a **Front Rest Clamp Bar(E)** into each end of the Front Rest. (Photo 3, Figure A.)
2. Secure the Front Rest using the four **M5 Screws(G)** up through the assembly into the Clamp Bars. (Photo 3, Figure B.)

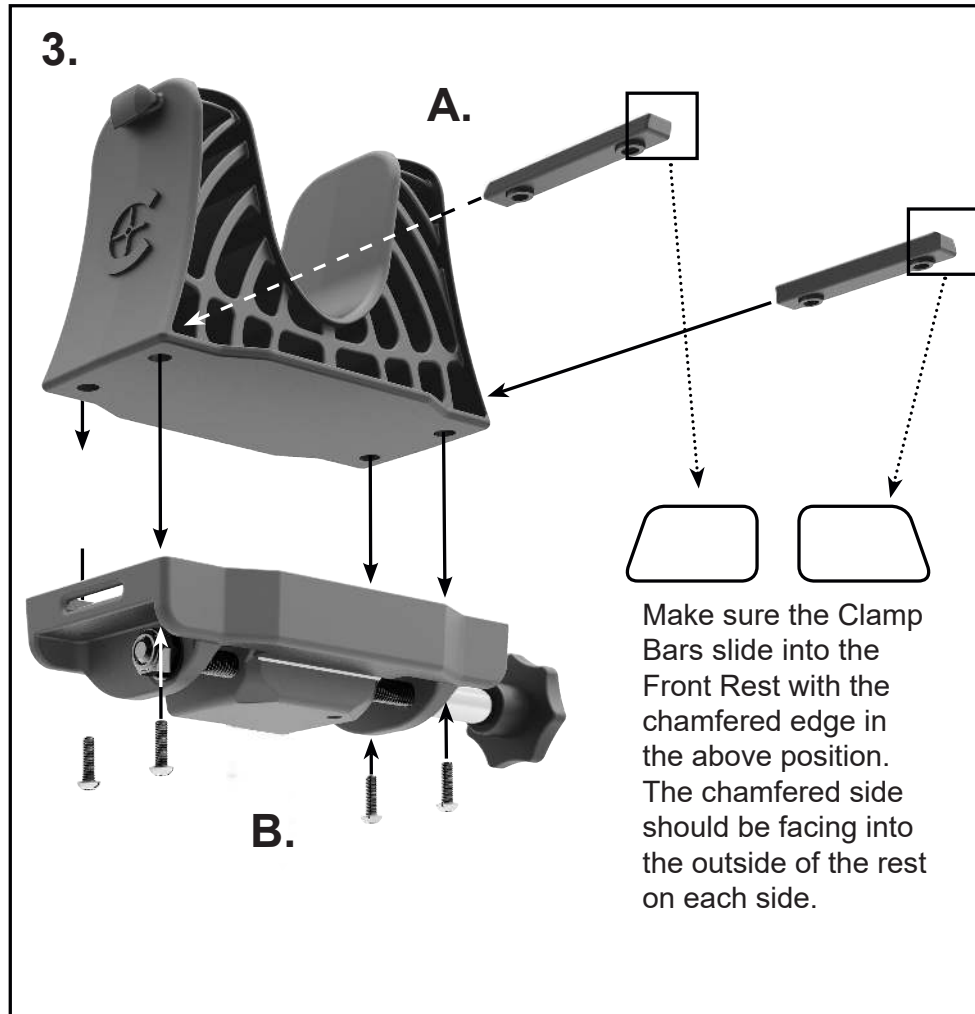

## Front Rest and Strap

1. Insert the Forend Strap through the narrow slot at the top of the Front Cradle Assembly and feed it all the way through the other side. The direction is your preference. To store the strap, hook each end to its corresponding hook near the top for the Front Rest. (Photo 4)

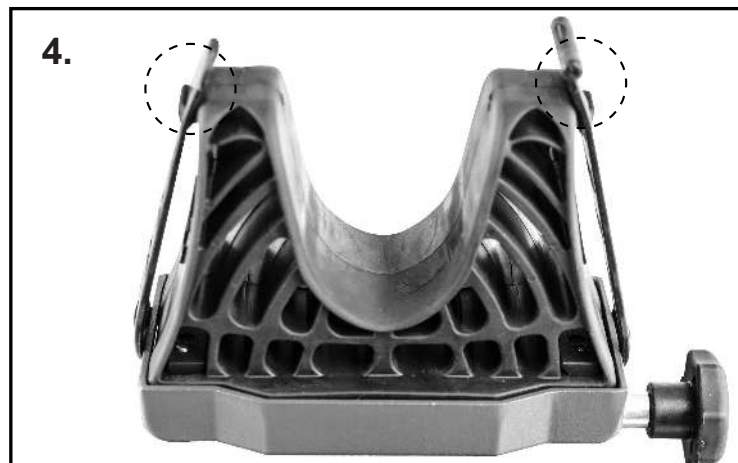

# ASSEMBLY

## Recoil Brace Assembly

1. Place the Recoil Brace into position as shown below. (photo 6 and 7)
2. Carefully align the holes and start a M8 screw from both sides, do not fully tighten until all M8 screws are installed and the threads are started.
3. Once all four M8 screws have been started fully tighten the screws.

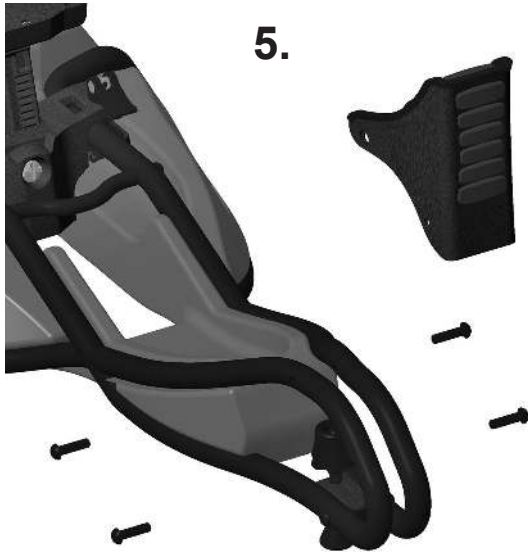

5.



6.

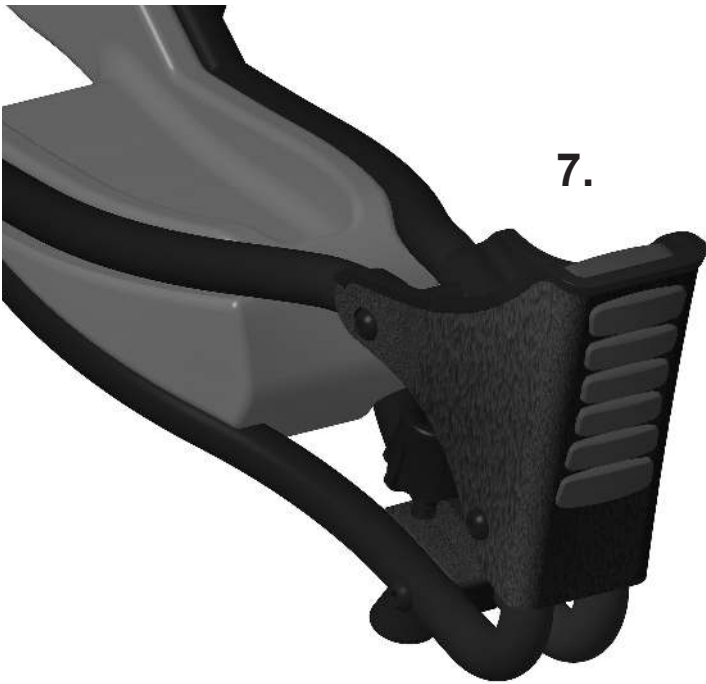

7.



1.

Your Hydrosled™ is fully assembled.  
Read the usage instructions before continuing.

# CARE INSTRUCTIONS

For best results store The Hydrosled™ in a clean and dry environment. Periodically lubricate the threads on the Elevation Wheel, Ram and rear foot to prevent corrosion.

## ⚠ IMPORTANT SAFETY INFORMATION ⚠

- Always practice safe firearm handling.
- Always unload and remove the firearm before attempting to add or remove weight from the weight tray.
- Always hold the forend of the firearm when shooting off of the Hydrosled™. If it is not held, the captured recoil can cause the firearm to jump out of the Front Rest, possibly causing damage to the firearm and/or injuring the shooter.

### Using the Forend Strap

If desired, use the Forend Strap to help secure the forend of your firearm during use. Unlatch the Forend Strap on both ends and pull the tongue shaped end through until the strap locks into position on the Front Cradle Assembly. Pull and position the forend strap to lock in both sides of the Front Rest. (Photo 8)

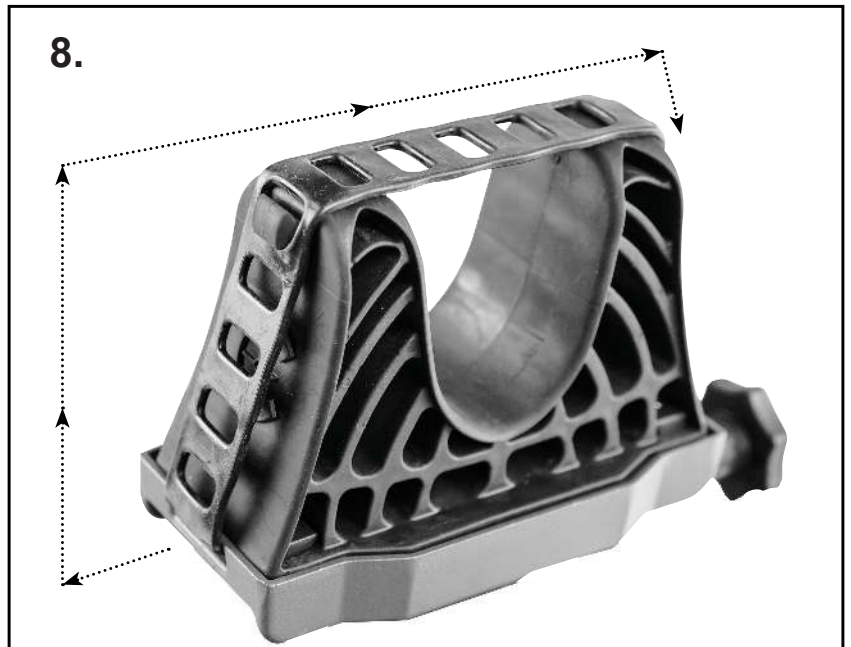

### Filling the Weight Tank with Media

The weight tank is designed to hold any media of your choice up to 44lbs

1. Traverse the Front Rest assembly to the back to provide more working space.
2. Place the Hydrosled™ on a level stable surface and remove the Fill Cap
3. Fill the weight tank with any media or mixture of media up to 44lbs.
4. Reinstall the fill cap

**NOTE:** Do not store liquids in tank for extended periods of time.

**NOTE:** Protect the other components of the Hydrosled™ when cleaning the weight tank.



## Windage Cradle Adjustments

The torque required to turn the knob for the Windage Cradle system has been adjusted at the factory, but the assembly is designed to be adjustable to meet your specific preference. Before adjusting, please refer to the picture below and familiarize yourself with the components that make up the Windage Cradle Sub-Assembly.

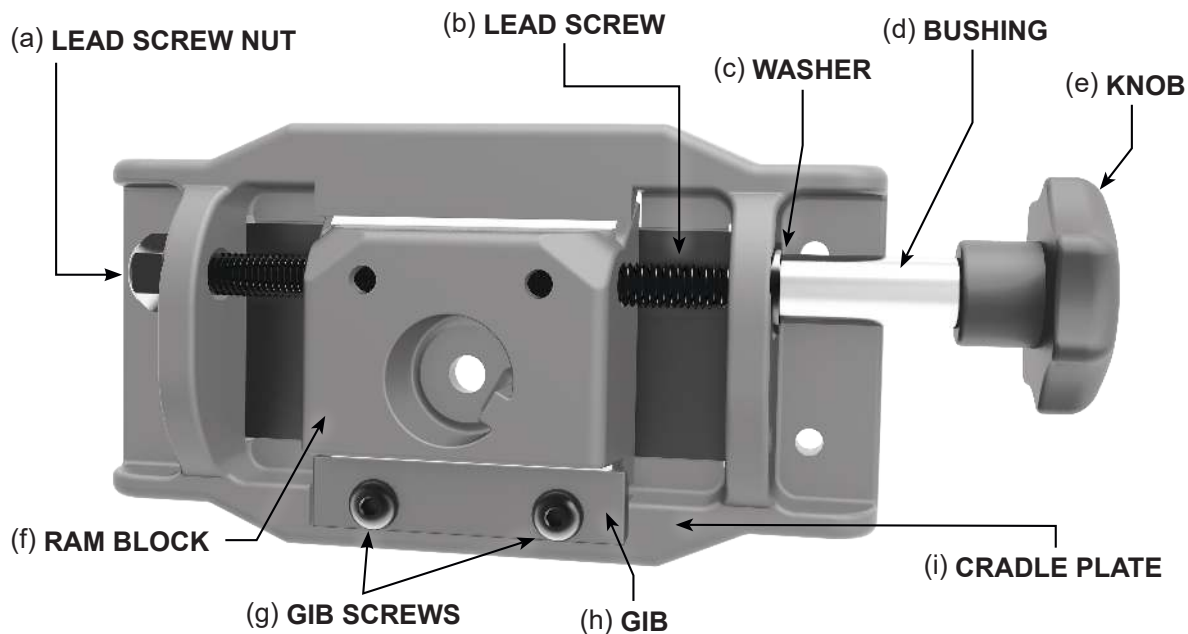

## Lead Screw Tension Adjustment

The **Lead Screw**(b), which moves the Windage Cradle plate left and right, should be adjusted to eliminate either excess backlash or unnecessary tension. Turn the **Knob**(e) two full revolutions in one direction. Then turn the Knob in the opposite direction one revolution.

- If the Knob felt like it loosened up when you turned it in the opposite direction, the Lead Screw might have excess backlash.
- If the Knob did NOT feel like it loosened when turned in the opposite direction, the Lead Screw might have unnecessary tension.

## To Remove Excess Backlash

Hold the **Lead Screw Nut**(a) with a 13mm wrench (an adjustable wrench or pair of pliers will work, as well) and turn the Knob clockwise, like you are tightening it. Once you feel it get snug, loosen it one fourth of a turn (Photo 13). Remove the wrench and try turning the Knob back and forth to see if it still feels like it has a loose spot (backlash). If the Knob feels loose for more than  $\frac{1}{4}$  of a revolution, tighten the Knob a little more while holding the Lead Screw Nut with a wrench or pliers. If it feels like it has less than  $\frac{1}{4}$  turn of backlash, you're done!

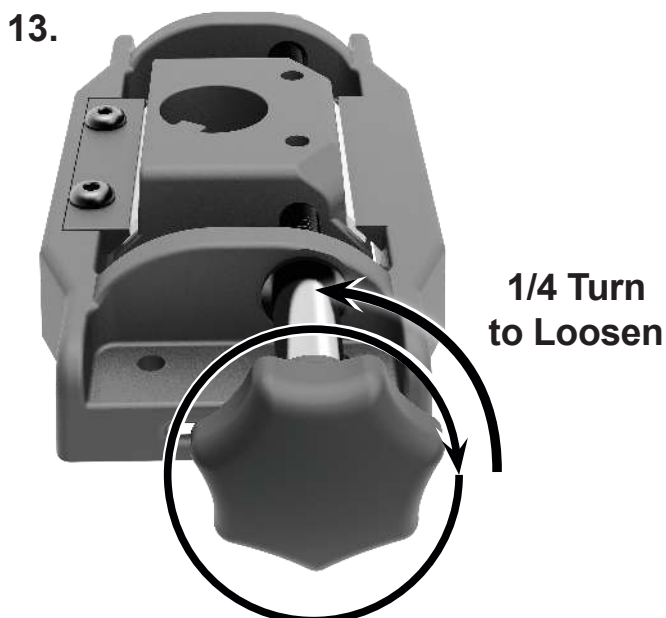

## To Remove Unnecessary Tension

Hold the Lead Screw Nut with a 13mm wrench (an adjustable wrench or pair of pliers will work, as well). Turn the Knob counter-clockwise, like you are loosening it,  $\frac{1}{4}$  of a revolution. Remove the wrench and try turning the Knob back and forth to see if it still feels tight when you change directions. If it still feels tight, loosen the Knob a little more while holding the Lead Screw Nut with a wrench or pliers. If it feels like it has a little bit of a loose spot before getting tight again (backlash), you're done!

**NOTE:** Due to manufacturing tolerances, it might not be possible to completely eliminate backlash. Up to  $\frac{1}{2}$  of a revolution of backlash is considered acceptable.

## Ram Block Resistance Adjustment

The resistance or tension felt when turning the Knob for Windage Cradle adjustments can be adjusted to suit your specific preference.

**NOTE:** Lead Screw tension MUST be set according to the instructions before adjusting the **Ram Block(f)** tension.

Turn the Knob until the Ram Block is centered in the **Cradle Plate(i)**. Using the supplied 3mm Hex Key, loosen both of the **Gib Screws(g)** several turns and then re-tighten them until they feel snug. Equally tighten both the Gib Screws with the same amount of torque. Once the Gib Screws are snug, an additional  $\frac{1}{4}$ - $\frac{1}{2}$  turn should be sufficient.

**NOTE:** Do not over-tighten the Gib Screws or you may permanently deform the Bearing Strips and/or the Gib(h).

Turn the Knob to test the resistance. If the resistance isn't tight enough, tighten the Gib Screws a little more and re-test. If it feels too tight, loosen the Gib Screws and re-test.

---

## MANUFACTURER TIPS:

- Using the normal shooting position and technique, place your shoulder solidly behind the rear rest and secure the forend and grip. Pull the firearm rearward to make certain the butt is securely seated against the rear rest.
- The Ram Lock only needs to be tightened enough to keep the front support from moving.
- The Elevation Wheel will keep the front support in place and only a small amount of tension is necessary.
- While many different types of weight are acceptable, lead shot will provide the greatest recoil reduction per pound.
- To make minor elevation adjustments use the rear fine elevation adjuster located on the rear foot.

# CALDWELL®

## ***HYDROSEED™***

